



INSTALLATION INSTRUCTIONS

50 Ohm CONNECTORS

Kabelwerk

EUPEN AG

E1018-Rev04/2006-11-08

cable

1/2" - STRAIGHT & RIGHT ANGLE CONNECTORS - O-Ring type



Please use cable preparation tools and refer to its instructions for use.

Follow the instruction process below only if these tools are not available.

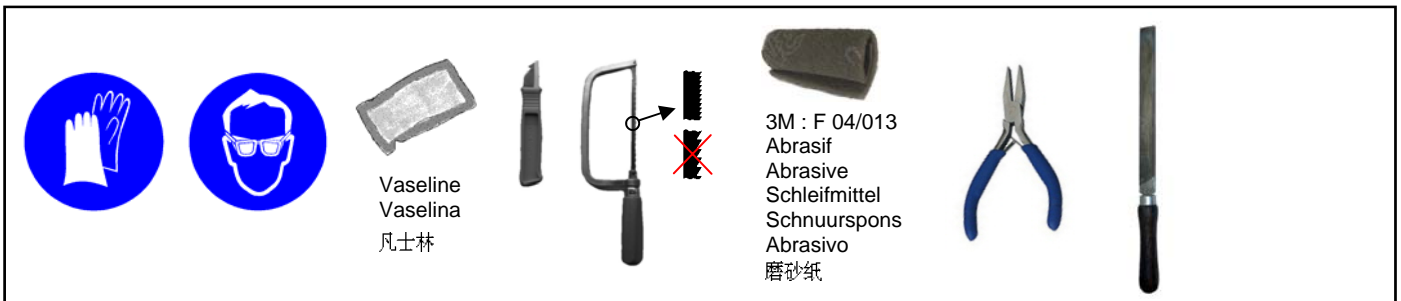

	NF, NM	NM50VL12	7/16M	7/16MVL12	7/16F	EIA
	2 x 19 mm	19 mm & 23 mm	19 mm & 23 mm & 32 mm	19 mm & 23 mm & 32 mm	19 mm & 24 mm	2 x 10 mm & 19 mm & 24 mm

MANUAL METHOD

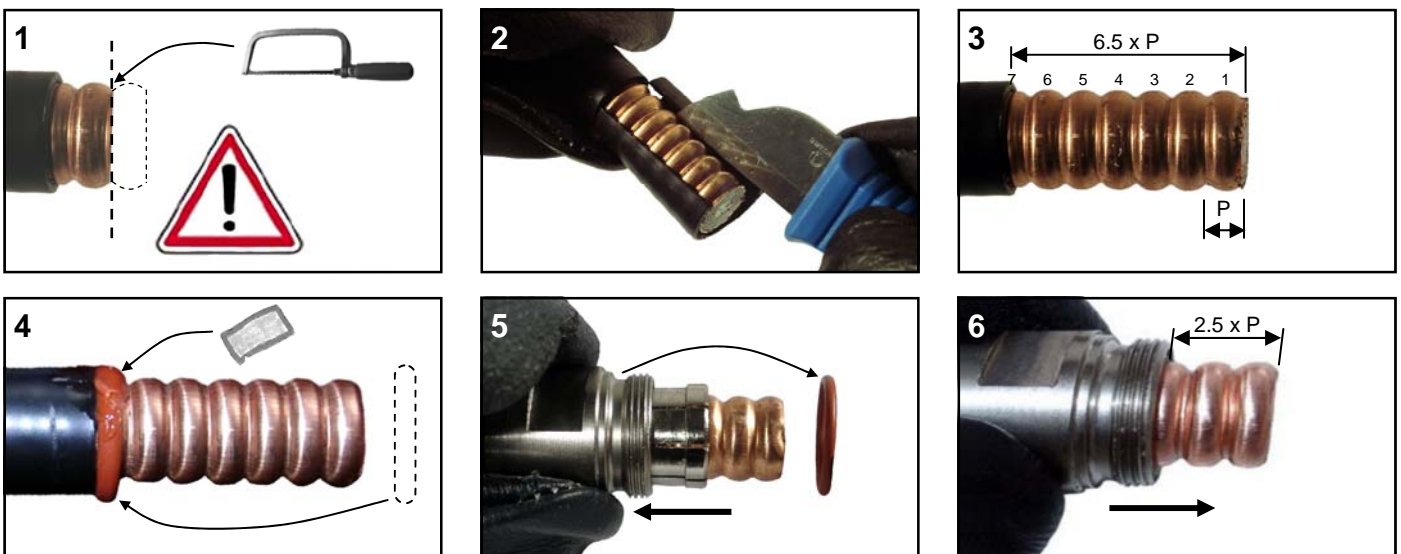



INSTALLATION INSTRUCTIONS

50 Ohm CONNECTORS

Kabelwerk | **EUPEN** AG

E1018-Rev04/2006-11-08

cable

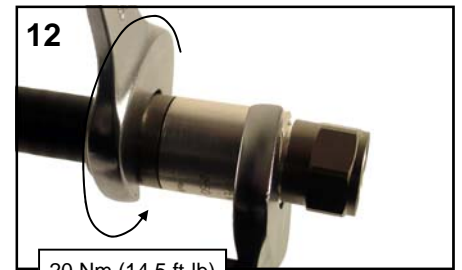
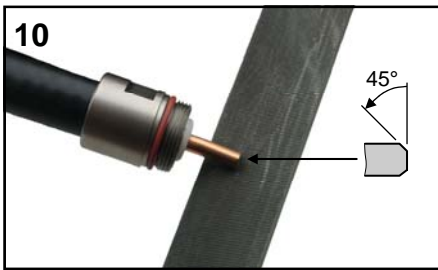
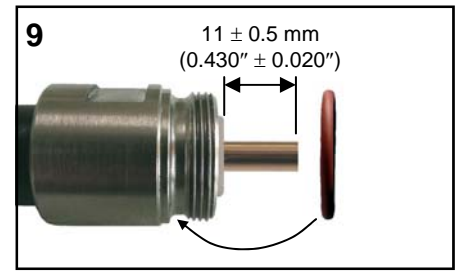
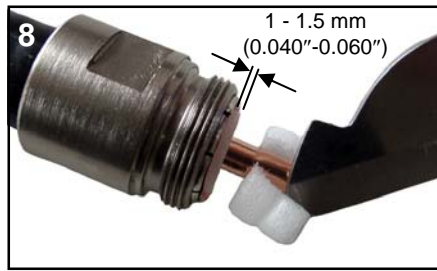
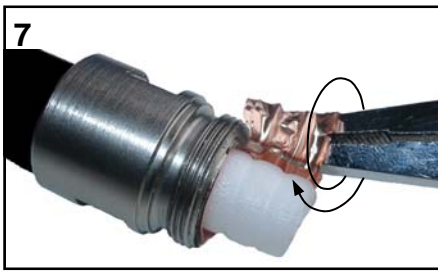

For any questions please contact KABELWERK EUPEN AG / for US Customer service call 1-800-419-5100

NOTICE:
KABELWERK EUPEN AG disclaims any liability or responsibility for the results of improper or unsafe installation practices.

AVIS:
KABELWERK EUPEN AG décline toute responsabilité en cas de non respect de ces instructions.

WAARSCHUWING:
KABELWERK EUPEN AG wijst elke verantwoordelijkheid van de hand in geval van het niet opvolgen van deze aanbevelingen.

BEMERKUNG:
KABELWERK EUPEN AG lehnt jede Verantwortung bei Nichtbeachtung dieser Instruktionen ab.

AVISO:
KABELWERK EUPEN AG rehusa todas las responsabilidades en caso de no respetar las instrucciones.

注意:
本公司声明对于不恰当或不安全的安装, 检验, 维修或拆卸操作所导致的后果不负任何义务和责任。





INSTALLATION INSTRUCTIONS

50 Ohm CONNECTORS

Kabelwerk | **EUPEN** AG

E1006-Rev04/2006-11-08

cable

1/2" - STRAIGHT & RIGHT ANGLE CONNECTORS - Sealant type



Please use cable preparation tools and refer to its instructions for use.

Follow the instruction process below only if these tools are not available.



	NF, NM	NM50AL12	7/16M	7/16MAL12	7/16F	EIA
	2 x 19 mm	19 mm & 23 mm	19 mm & 23 mm & 32 mm	19 mm & 23 mm & 32 mm	19 mm & 24 mm	2 x 10 mm & 19 mm & 24 mm

MANUAL METHOD

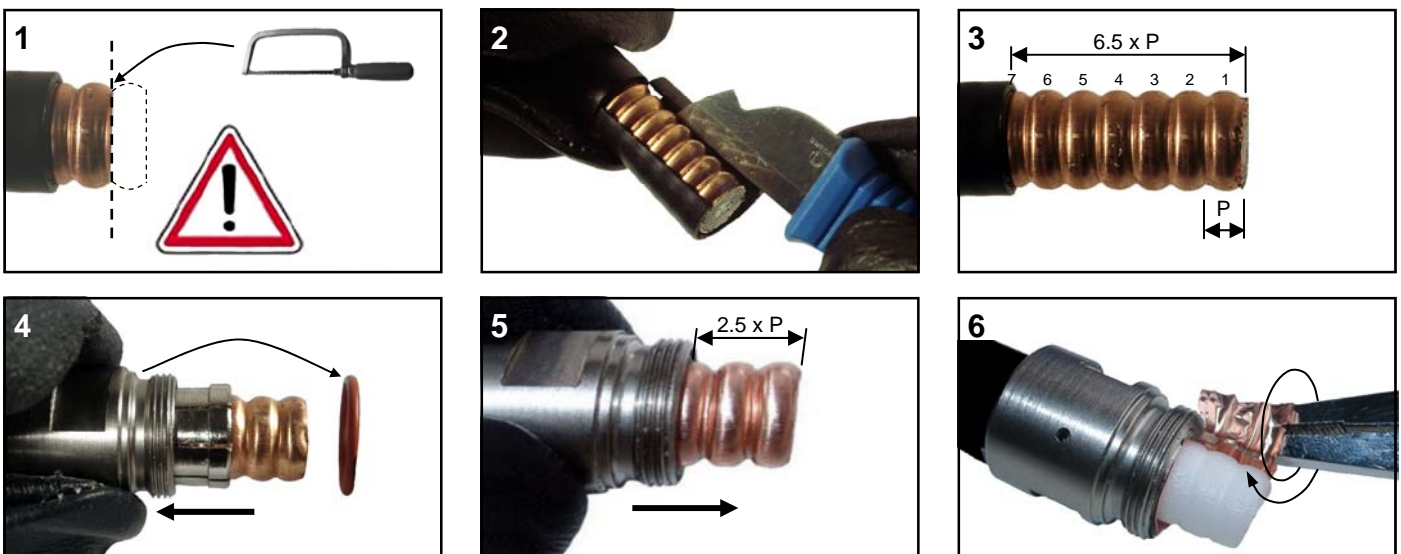



INSTALLATION INSTRUCTIONS

50 Ohm CONNECTORS

Kabelwerk | **EUPEN** AG

E1006-Rev04/2006-11-08

cable

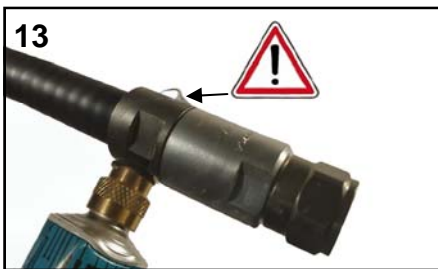
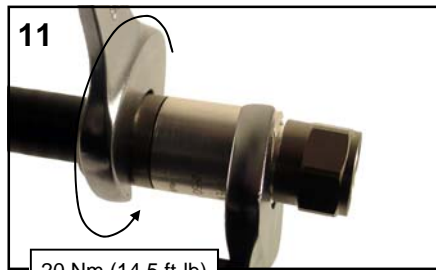
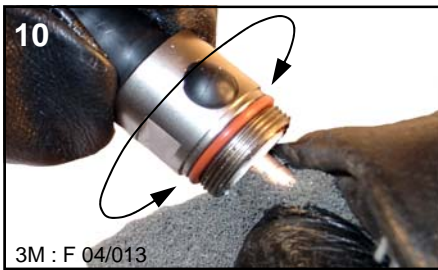
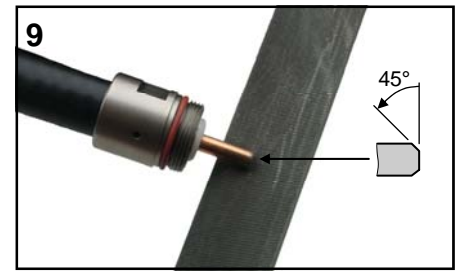
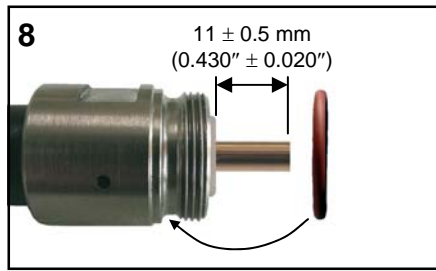
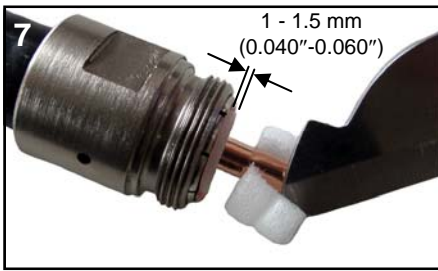

For any questions please contact KABELWERK EUPEN AG / for US Customer service call 1-800-419-5100

NOTICE:
KABELWERK EUPEN AG disclaims any liability or responsibility for the results of improper or unsafe installation practices.

AVIS:
KABELWERK EUPEN AG décline toute responsabilité en cas de non respect de ces instructions.

WAARSCHUWING:
KABELWERK EUPEN AG wijst elke verantwoordelijkheid van de hand in geval van het niet opvolgen van deze aanbevelingen.

BEMERKUNG:
KABELWERK EUPEN AG lehnt jede Verantwortung bei Nichtbeachtung dieser Instruktionen ab.

AVISO:
KABELWERK EUPEN AG rehusa todas las responsabilidades en caso de no respetar las instrucciones.

注意:
本公司声明对于不恰当或不安全的安装, 检验, 维修或拆卸操作所导致的后果不负任何义务和责任。

